



Model 3731/3732



Doc: CH-3731/01

Nov 2006

FIP Air operated 3 way PVC ball valve

Reduced bore PVC 3 way ball valve, fitted with CH-air 'A' type pneumatic actuator. Standard version has EPDM seals, but Viton (FPM) seals are available as an option. Supplied assembled and dry bench function tested. Minimum of 80 psi (5.5 bar) air supply pressure to the actuator is required.

3731 With double acting actuator

3732 With spring return actuator

Size range from 1/2" to 2" (D20 to D63)

WRAS approved product for use on potable water.

Applications:

PVC is odourless and tasteless and is used in many applications such as potable water and many food processing. PVC has good chemical resistance and resists most solutions of acids, alkalis and salts, and solvents that can be diluted with water acids. It is not resistant to aromatic and chlorinated carbons.

Actuators sized on a maximum differential pressure of 10 bar wet service, if the intended duty is above this differential, or dry (air or gas) call to check actuator sizing as a larger output actuator may be required.

Valve Specifications:

Body	PVC
Ball	PVC
Seats	PTFE
Pressure rating	16 bar at 20C
Valve temp limits	0 to +60°C
Actuator temp limits	-20 to + 70°C

3 Way ball valves –flow patterns:

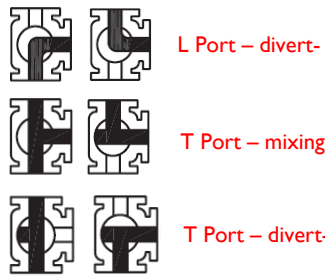

Quick guide to the CH-air A Type actuator standard features :

Robust rack and pinion construction

High accuracy machining of components

ATEX Ex II 2 GD approved for use in hazardous areas

CE Approved

Guaranteed for 1,000,000 cycles

Balanced air & spring strokes in spring return version

Safe to dismantle for routine maintenance

Compliant with all actuator standards

Accessories are easy to mount

Hard anodised aluminium body

ENP coated option (Extra cost)

Teflon® coated option (Extra cost)

Stainless steel version (Extra cost)

Accessories:

Solenoid control:

This provides electrical control of the valve. The air is constantly supplied to the solenoid which in turn controls the air to and from the actuator. The solenoid direct mounts to the actuator using the actuator's Namur connection.

Position Confirmation:

Remote end of travel confirmation can be provided by adding a top mounted limit switch box. A variety of switch options and housings are available. See our LSB range for details.

Position control:

The standard on/ off function can be converted to modulating function, using either a 3-15psi or 4-20mA control signal, by adding a pneumatic or electro-pneumatic positioner. See our YT range for details.



Model 3731/3732



Doc: CH-3731/01

Nov 2006



Air operated 3 way PVC ball valve - Dimensions (to nearest mm)

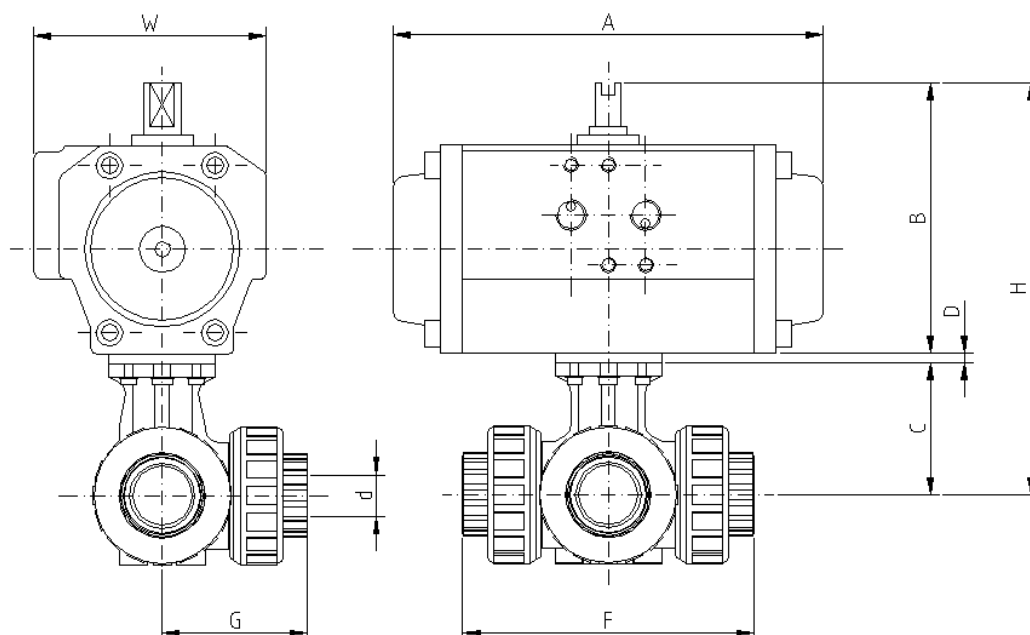

Double Acting											
Imperial	Model	A	B	C	D	F	G	H	W	Kilos	Metric Pipe OD / Bore 'd'
1/2"	CH042	160	77	50	0	118	59	127	61	1.5	20 / 15
3/4"	CH042	160	77	57	0	145	73	134	61	1.7	25 / 20
1"	CH042	160	77	62	0	160	80	139	61	1.9	32 / 25
1 1/4"	CH050	138	87	77	15	189	95	179	75	2.7	40 / 32
1 1/2"	Ch050	138	87	81	15	219	110	183	75	3.1	50 / 40
2"	CH050	138	87	98	15	267	134	200	75	4.3	63 / 50
Spring Return											
1/2"	CH050SR	138	87	50	0	118	59	137	75	1.7	20 / 15
3/4"	CH050SR	138	87	57	0	145	73	144	75	2.0	25 / 20
1"	CH050SR	138	87	62	0	160	80	149	75	2.2	32 / 25
1 1/4"	CH063SR	156	103	77	15	189	95	195	86	3.5	40 / 32
1 1/2"	CH063SR	156	103	81	15	219	110	199	86	3.9	50 / 40
2"	CH063SR	156	103	98	15	267	134	216	86	5.1	63 / 50

Subject to alteration without notice. Uncontrolled copy, not subject to automatic updates