



Model 6201/6202



Doc: CH-6201/02

June 2009

Air operated lugged & tapped PNI6 butterfly valve

Lugged pattern butterfly valve with stainless steel disc (see below for liner), fitted with CH-air 'A' type pneumatic actuator. Supplied assembled and dry bench function tested. Minimum of 80 psi (5.5 bar) air supply pressure to the actuator is required.

- 6201E EPDM liner with double acting actuator
- 6202E EPDM liner with spring return actuator
- 6201N NBR liner with double acting actuator
- 6202N NBR liner with spring return actuator

With EPDM, the valve is WRAS approved.

Applications:

Water and most non-corrosive media, subject to compatibility with wetted parts in contact with media. Actuators sized on a maximum differential pressure of 10 bar wet service, if the intended duty is above this differential, or dry (air or gas) call to check actuator sizing as a larger output actuator may be required.

Maximum working temperature of assembly is +80C. If the intended duty is at a higher temperature than this, contact us for information on high temperature liner options.

Valve Specifications:

Body	Ductile iron
Disc	Stainless steel
Liner	Standard is EPDM or NBR (others available)
Pressure rating	DN 50-150 16 bar, Rest 10 bar . (16 bar valves available but may be from different manufacturer)
Valve temp limits	-20 to +90°C
Actuator temp limits	-20 to + 70°C

Accessories:

Solenoid control:

This provides electrical control of the valve. The air is constantly supplied to the solenoid which in turn controls the air to and from the actuator. The solenoid direct mounts to the actuator using the actuator's Namur connection.

Position Confirmation:

Remote end of travel confirmation can be provided by adding a top mounted limit switch box. A variety of switch options and housings are available
See our LSB range for details.

Position control:

The standard on/ off function can be converted to modulating function, using either a 3-15psi or 4-20mA control signal, by adding a pneumatic or electro-pneumatic positioner.
See our YT range for details.



Quick guide to the CH-air A Type actuator standard features :

Robust rack and pinion construction

High accuracy machining of components

ATEX Ex II 2 GD approved for use in hazardous areas

CE Approved

Guaranteed for 1,000,000 cycles

Balanced air & spring strokes in spring return version

Safe to dismantle for routine maintenance

Compliant with all actuator standards

Accessories are easy to mount

Hard anodised aluminium body

ENP coated option (Extra cost)

Teflon® coated option (Extra cost)

Stainless steel version (Extra cost)



Model 6201/6202



Doc: CH-6201/02

June 2009

Air operated lugged & tapped butterfly valve - Dimensions (to nearest mm)

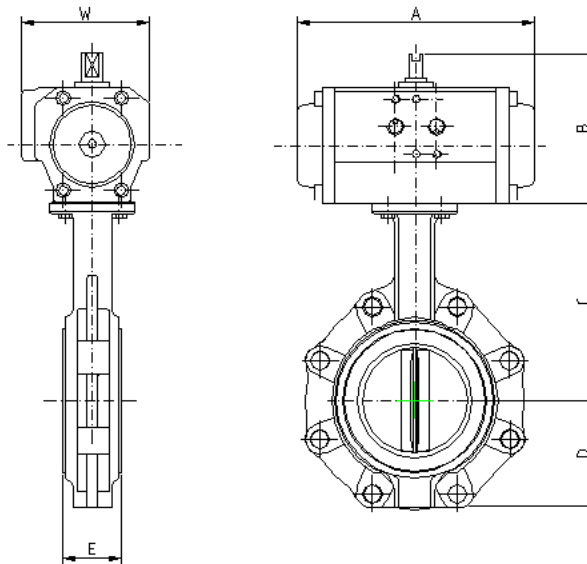

Double Acting										
	Model	A	B	C	D	E	H	W	Kilos	Standard flange
2"	CH063	156	103	210	84	43	313	86	6.4	PN16
2 1/2"	CH063	156	103	227	93	46	330	86	7.1	PN16
3"	CH063	156	103	261	104	46	364	86	10.2	PN16
4"	CH075	210	120	282	115	52	402	94	12.7	PN16
5"	CH075	210	120	307	127	56	427	94	13.0	PN16
6"	CH100	281	145	353	150	56	498	120	18.9	PN16
8"	CH100	281	145	404	176	60	549	120	24.6	PN10
10"	CH115	310	172	478	212	68	650	134	41.7	PN10
12"	CH125	362	172	528	237	78	700	141	52.4	PN10
Spring Return										
2"	CH063SR	156	103	210	84	43	313	86	6.7	PN16
2 1/2"	CH063SR	156	103	227	93	46	330	94	7.8	PN16
3"	CH075SR	210	120	261	104	46	381	94	11.9	PN16
4"	CH085SR	228	130	282	115	52	412	104	14.6	PN16
5"	CH100SR	281	145	307	127	56	452	120	16.8	PN16
6"	CH125SR	362	185	353	150	56	538	141	26.9	PN16
8"	CH145SR	390	205	404	176	60	609	163	39.1	PN10
10"	CH160SR	462	196	478	212	68	674	176	51.0	PN10
12"	CH180SR	474	270	528	237	78	798	196	76.2	PN10