



CH-air - Conformity & valve mounting



Doc: CH/Conf/01

Jan 2006

CH-air actuators conform to the following standards :

VDI-VDE 3845 (NAMUR)

Mounting of position control & monitoring devices
Eg: Positioners or limit switchboxes

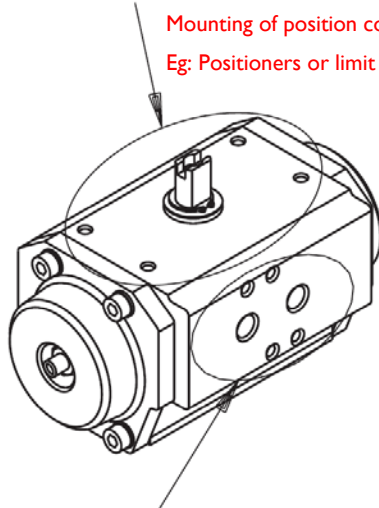

VDI-VDE 3845 (NAMUR)

Mounting of Namur pilot solenoid valves

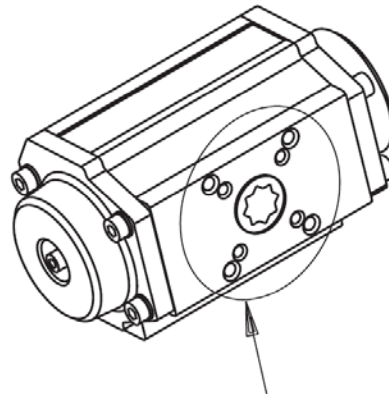

ISO 5211 - DIN 3337

Valve mounting

DA

Opening by air.
Counter-clockwise

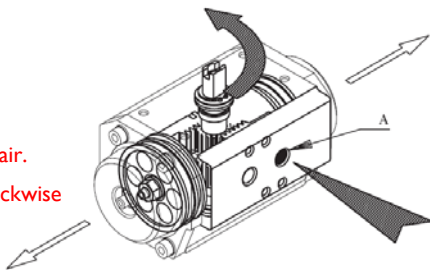

Closing by air
Clockwise

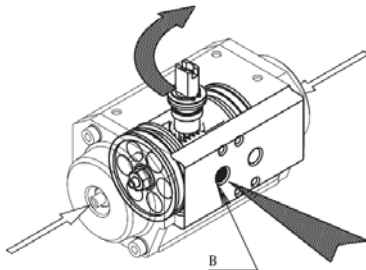

Double acting actuators - standard shaft rotation

SR

Opening by air
Counter-clockwise

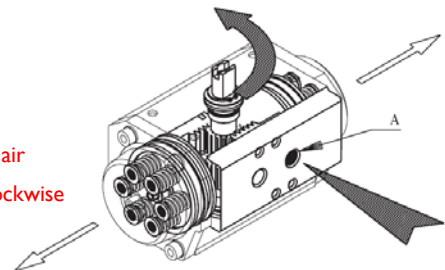

Closing by springs
Clockwise

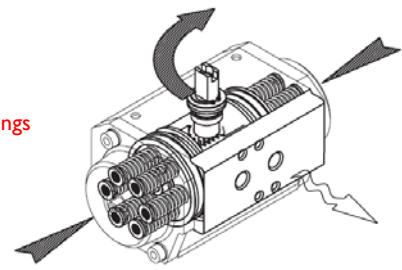

Single acting actuators - standard shaft rotation



Valve & accessory mounting



Doc: CH/Conf/01

Jan 2006

Where required, fit ISO5211 mounting kit

ISO5211 bracket

Drive adaptor

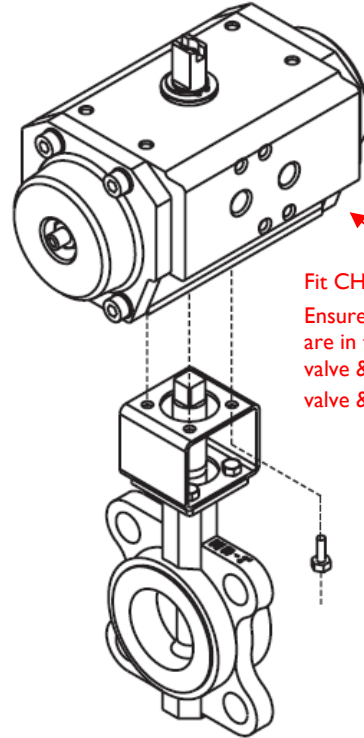
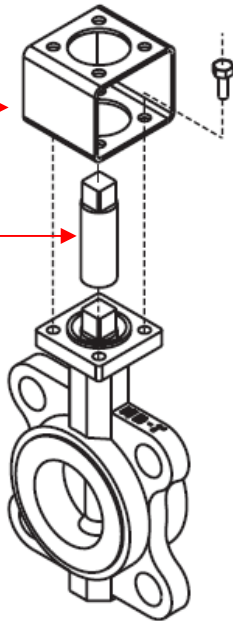

Fit CH-air actuator.
Ensure valve and actuator are in the same position ie: valve & actuator open, or valve & actuator closed.

Fit limit switchbox or positioner

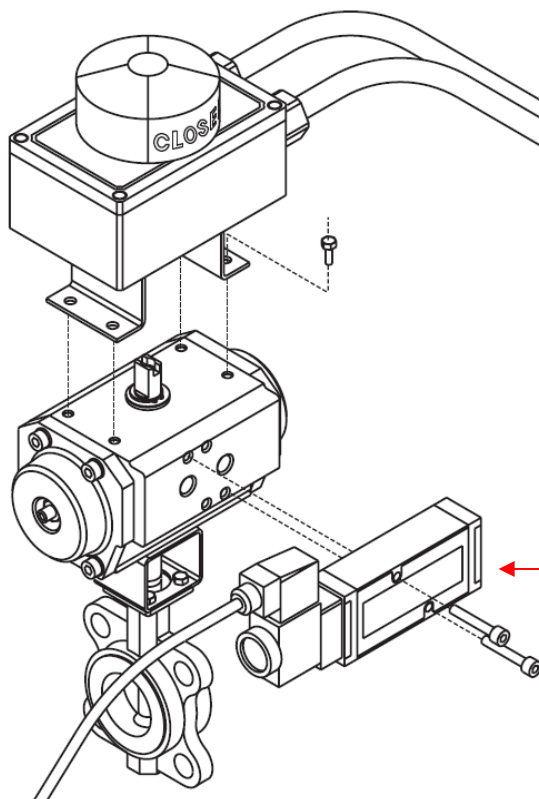

Fit Namur pilot solenoid